

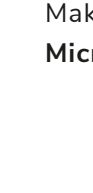

METAMASK

— SETUP GUIDE —



On PC

MetaMask is a cryptocurrency wallet that runs on web browsers in any operating system such as Windows, Mac, Ubuntu, Linux.

Note

Make sure you are using a browser that supports MetaMask such as **Chrome, Brave, Firefox or Microsoft Edge**.

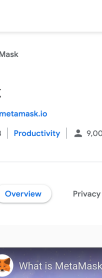

Chrome



Firefox



Brave

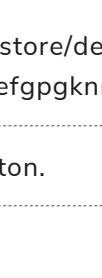

Edge

If your PC does not have any of the above browsers, please download it from the links below.
Google Chrome will be used in this demonstration.



Chrome <https://www.google.com/intl/en-us/chrome/>



Firefox <https://www.mozilla.org/en-US/firefox/new/>



Brave <https://brave.com/download/>



Edge <https://www.microsoft.com/en-us/edge>

1

Download MetaMask

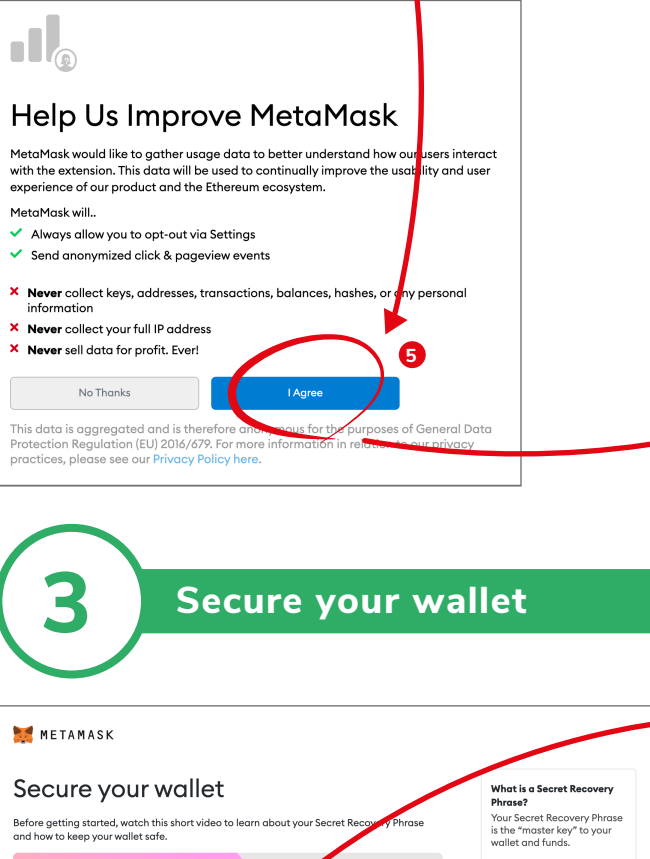

Download MetaMask extension from Chrome Web Store.

<https://chrome.google.com/webstore/detail/metamask/nkbihfbeigaeaoheifmkdbfegpgknn?hl=en>

1 Click on **Add to Chrome** button.

2 Click on **Add Extension** button.

3 After the extension is successfully installed, you'll be redirected to the Welcome to MetaMask page. Click on **Get Started** button.

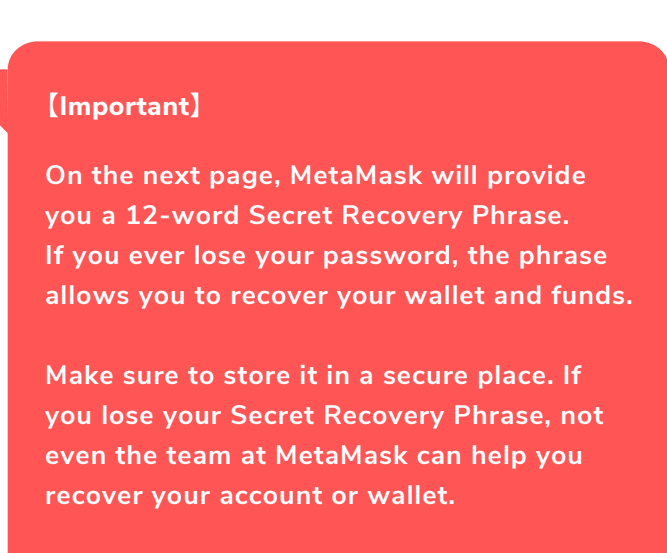

2

Create a new MetaMask wallet



4 Click on **Create a Wallet**.

5 Next page is about MetaMask asking your permission to collect your usage data. You may choose either **No Thanks** or **I Agree**.

6 After creating a password and checking off the terms and conditions, click on **Create**.

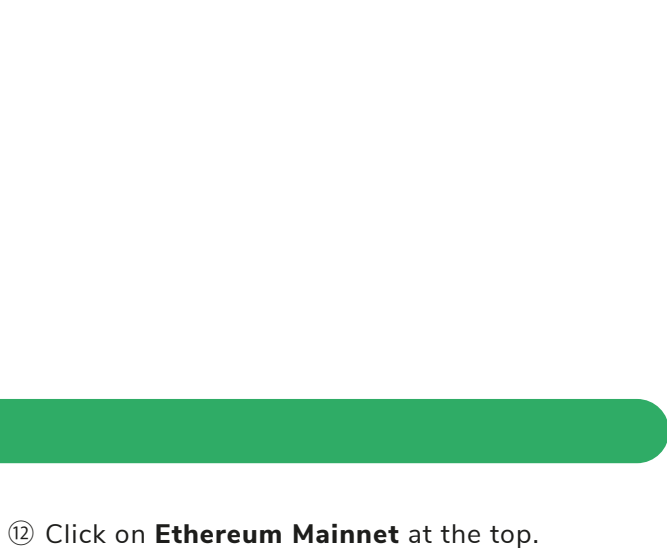
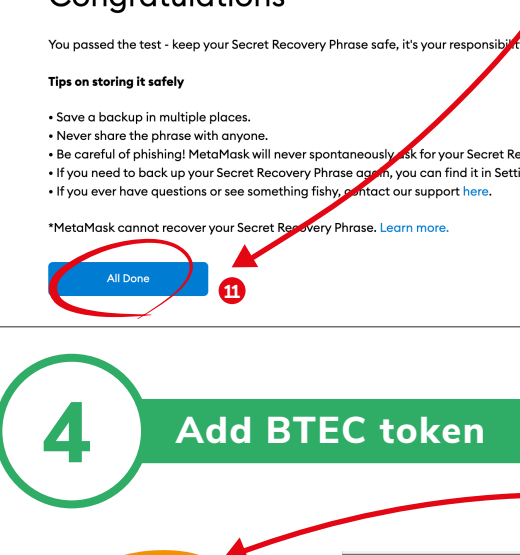

3

Secure your wallet

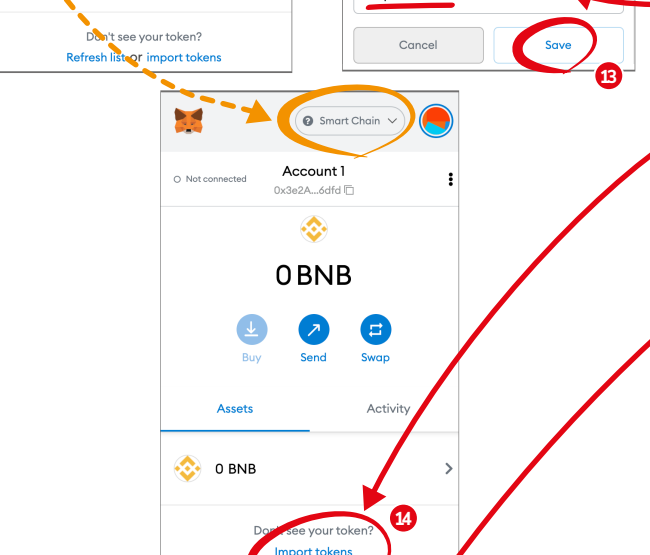

7 You are recommended to watch the short video about Secret Recovery Phrase. Click **Next** after you have watched and taken note of the information.

[Important]
On the next page, MetaMask will provide you a 12-word Secret Recovery Phrase. If you ever lose your password, the phrase allows you to recover your wallet and funds.
Make sure to store it in a secure place, if you lose your Secret Recovery Phrase, not even the team at MetaMask can help you recover your account or wallet.
Never ever share your Secret Recovery Phrase with anyone. The MetaMask team (and TEE-coin) will never ask you for it. If anyone or any website asks you to share it, they are trying to scam you.

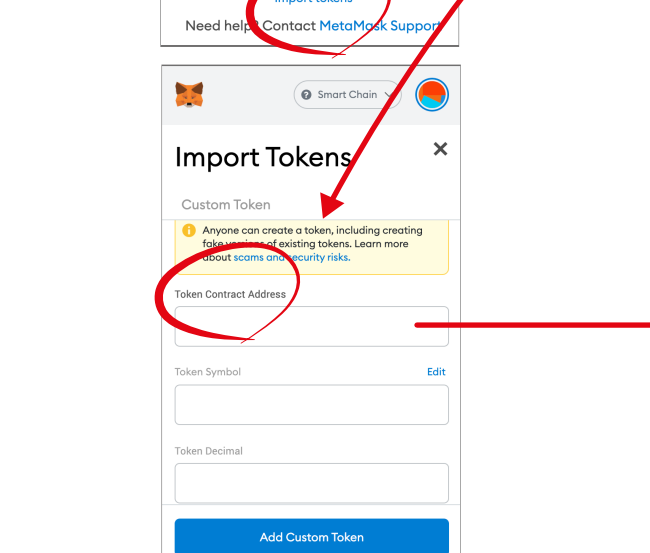

8 Click on the grey lock area to reveal your own private Secret Recovery Phrase.

9 Record the shown Secret Recovery Phrase in the exact same order and store it securely. Then, click on **Next**.

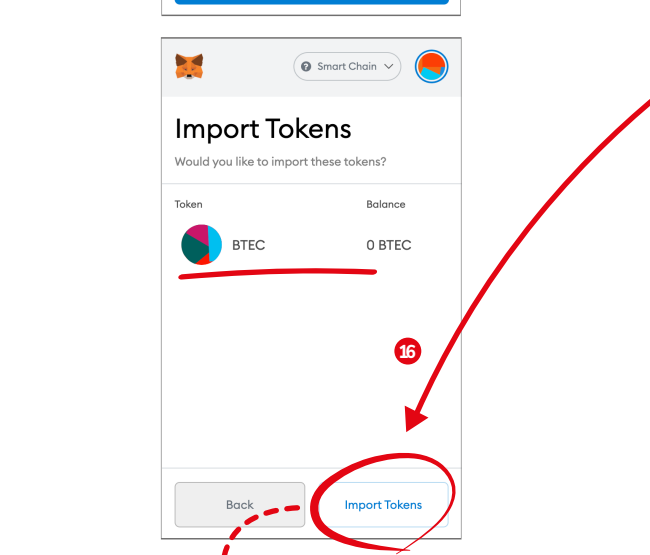

10 Select the phrase below in order to confirm that the Secret Recovery Phrase is correct. Then, click on **Confirm**.

11 Congratulations. You have successfully created your new MetaMask wallet and you are ready to go. Click on **All Done**.

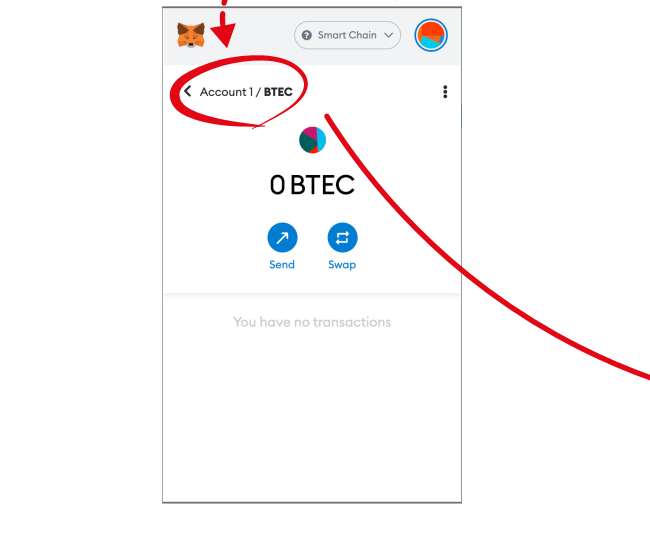

4

Add BTEC token

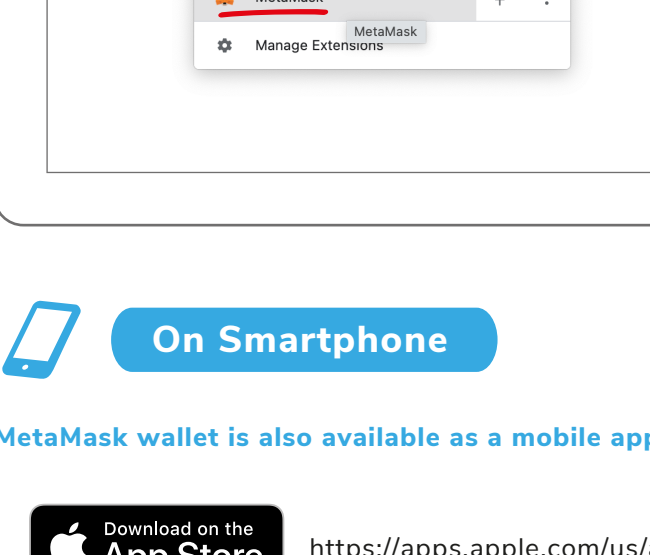

12 Click on **Ethereum Mainnet** at the top. You'll be given a list of test networks. Click on **Custom RPC** at the bottom of the list, which is an option to add a custom network.

13 Fill in the information as below.

Network Name : Smart Chain
New RPC URL : <https://bsc-dataseed.binance.org/>
Chain ID : 56
Currency Symbol : BNB
Block Explorer URL : <https://bscscan.com>

14 When the network connection is complete, your MetaMask wallet will be switched to the Binance Smart Chain. Then, click on **Import Tokens**.

15 Fill in the information as below.

Token Contract Address :
0xaf307c4ea25c8a2a7029dc0322396a6b4b00a0fc
New RPC URL :
Chain ID :
Currency Symbol :
Block Explorer URL :
The Token Symbol and Token Decimal will be automatically filled in.
Click on **Add Custom Token**.

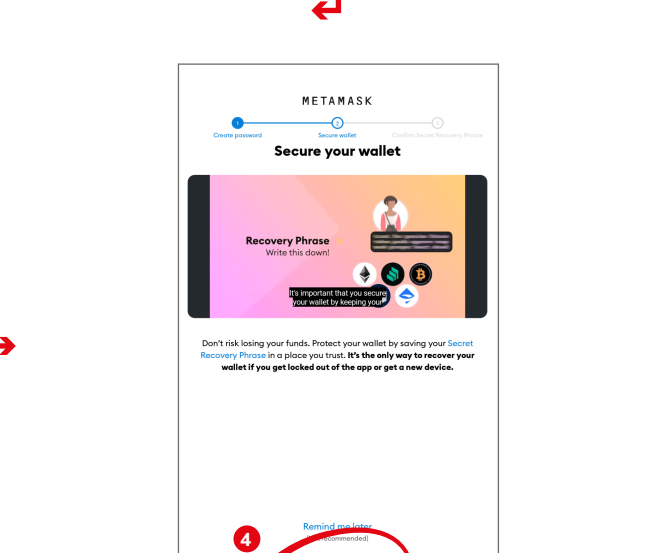
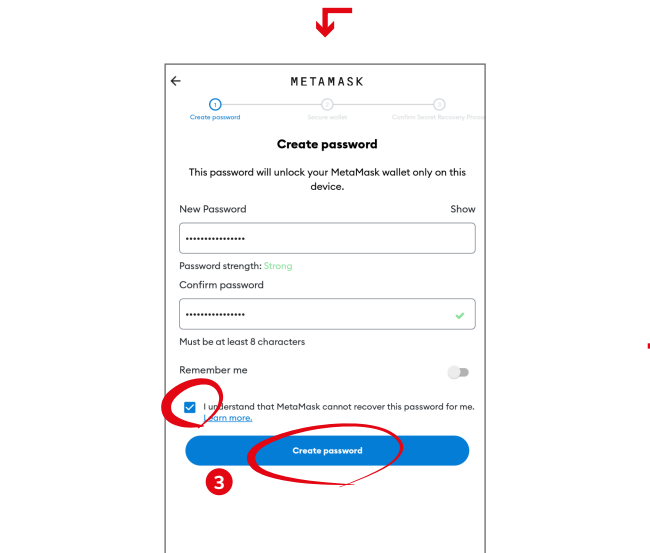

16 Confirm that BTEC is displayed. Click on **Import Tokens**.

17 BTEC token is now successfully added under your assets.

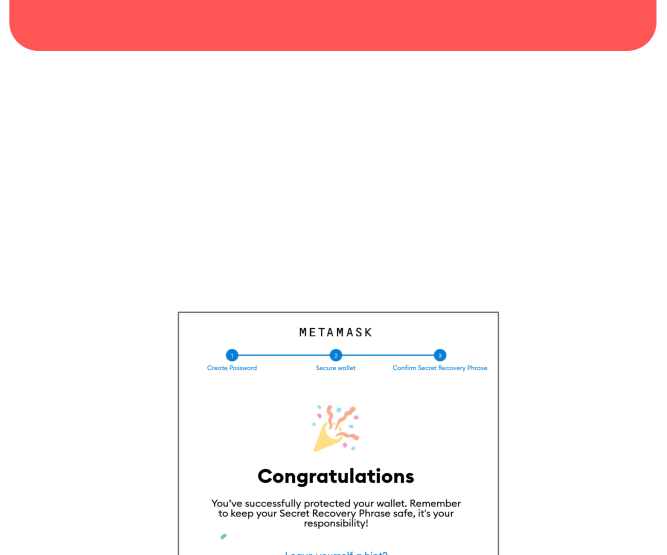
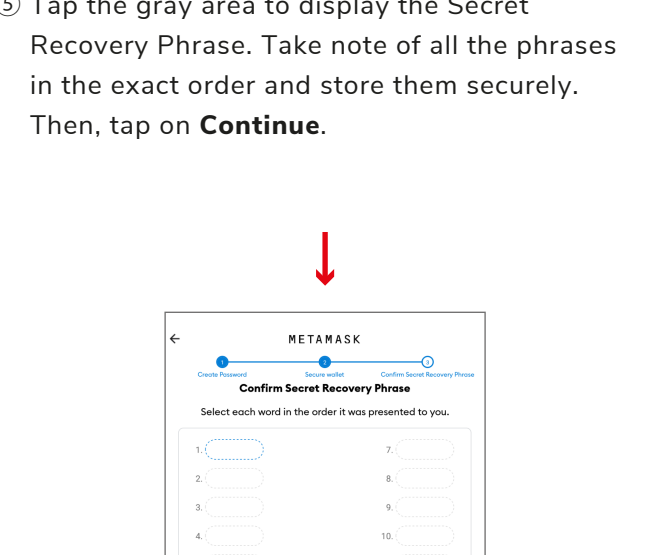
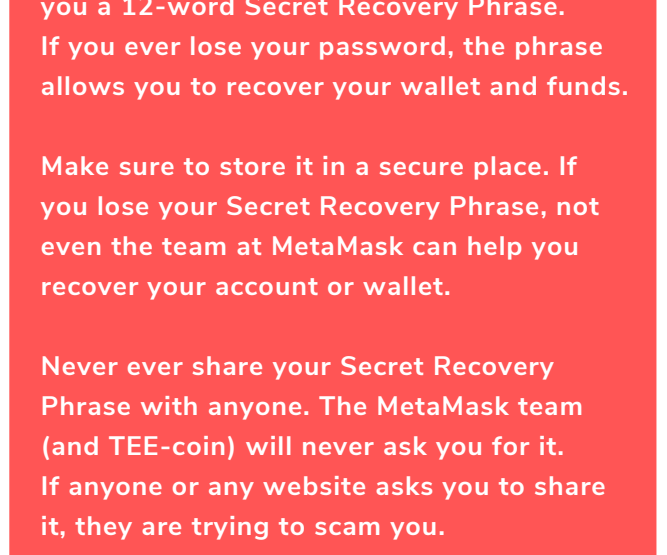
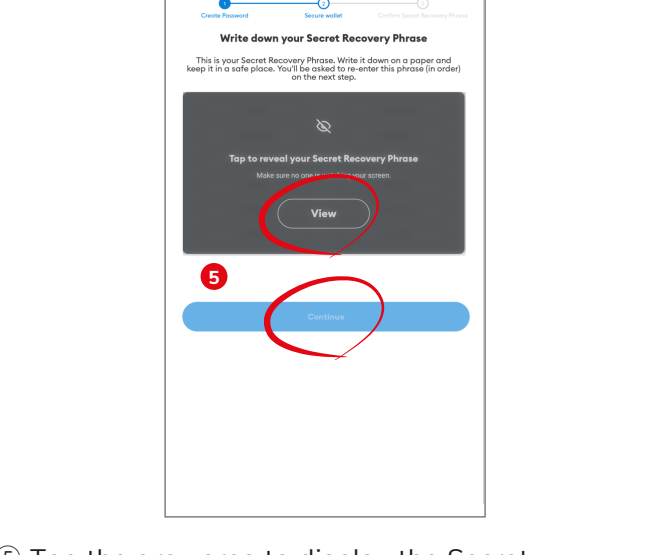

MetaMask extension on Google Chrome

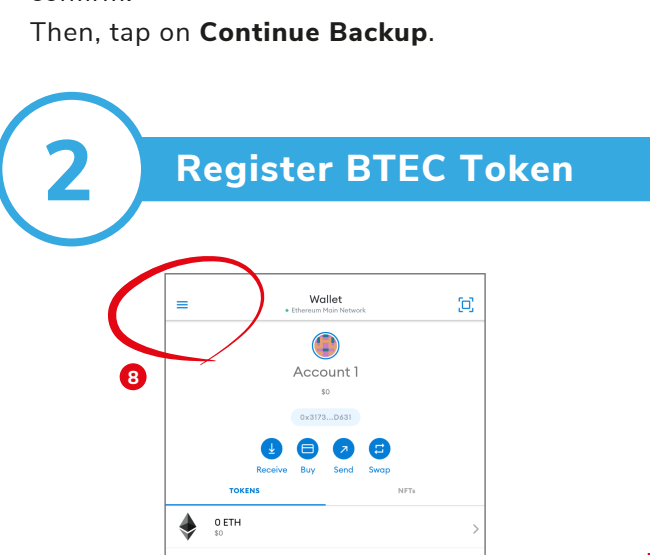

To access the MetaMask wallet again after you close the tab, navigate to the top-right of your browser, click on the puzzle icon and choose MetaMask among the browser extensions.
You may also pin the extension for easier access in the future.

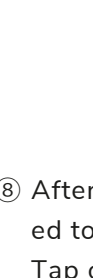

On Smartphone

MetaMask wallet is also available as a mobile app and can be installed on iOS and Android devices.



Download on the App Store <https://apps.apple.com/us/app/metamask-blockchain-wallet/id1438144202>



GET IT ON Google Play <https://play.google.com/store/apps/details?id=io.metamask&hl=en&gl=US>

1

MetaMask Wallet App Setup

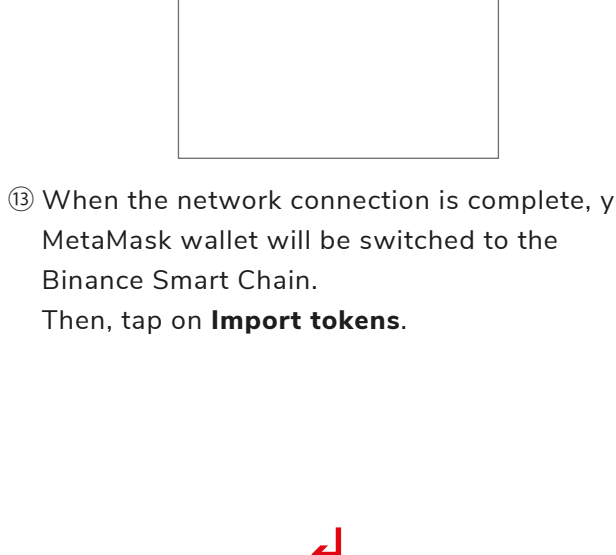
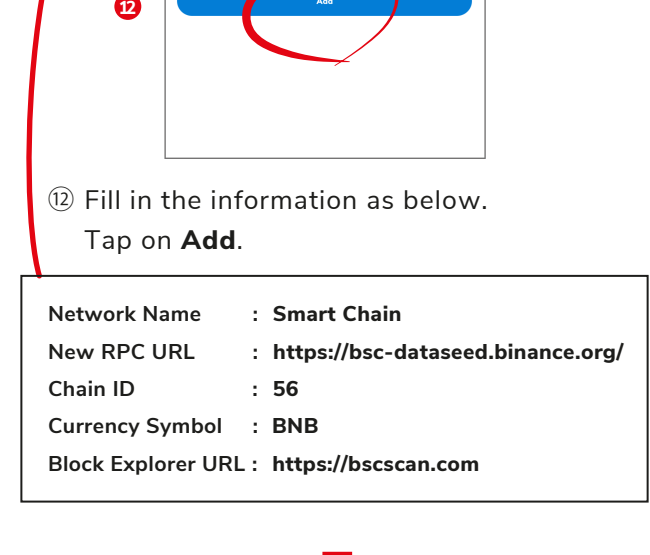

1 Install MetaMask app and tap on **Get Started**.

2 Tap on **Create a new wallet**.

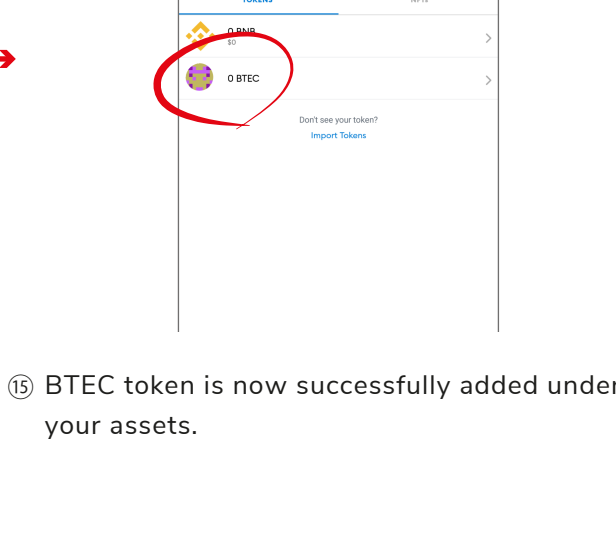
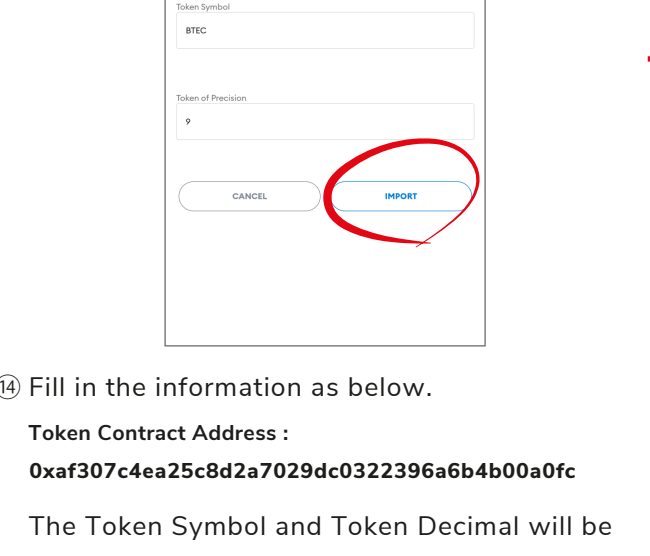

3 Create password for the wallet.
Check I understand that MetaMask cannot recover this password for me. Please take note that this password is used to unlock the wallet only on this device. You may also use fingerprint or face authentication if your device supports it.

4 You are recommended to watch the short video about Secret Recovery Phrase. Click **Start** after you have watched the video.



[Important]
On the next page, MetaMask will provide you a 12-word Secret Recovery Phrase. If you ever lose your password, the phrase allows you to recover your wallet and funds.
Make sure to store it in a secure place, if you lose your Secret Recovery Phrase, not even the team at MetaMask can help you recover your account or wallet.
Never ever share your Secret Recovery Phrase with anyone. The MetaMask team (and TEE-coin) will never ask you for it. If anyone or any website asks you to share it, they are trying to scam you.

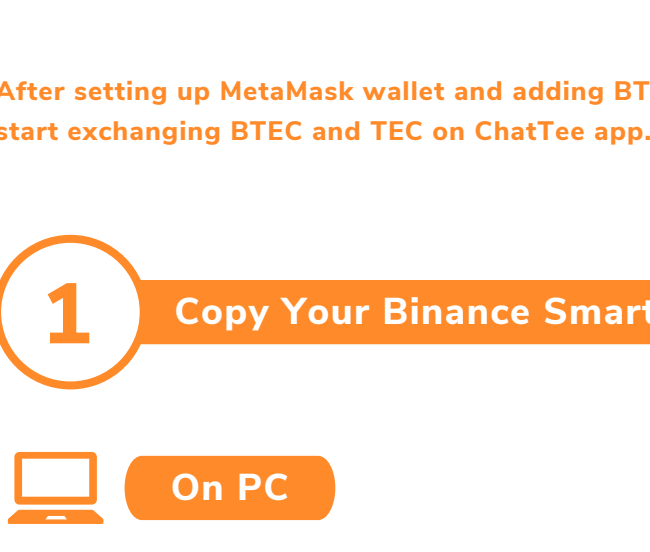

5 Tap the gray area to display the Secret Recovery Phrase. Take note of all the phrases in the exact order and store them securely. Then, tap on **Continue**.

6 Congratulations. You have successfully created your new MetaMask wallet. Tap on **Done**.

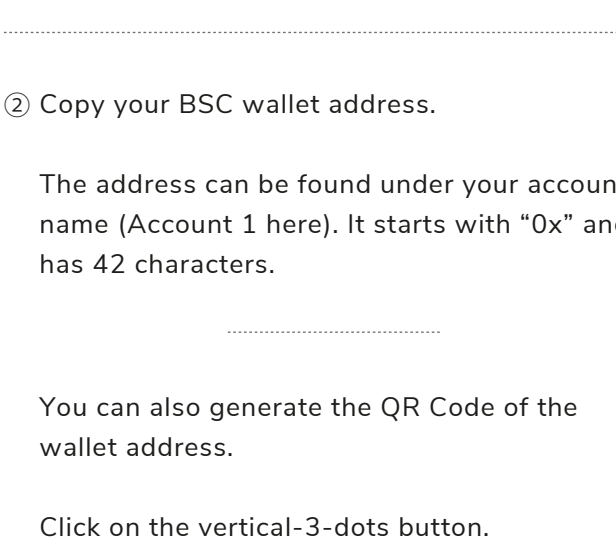
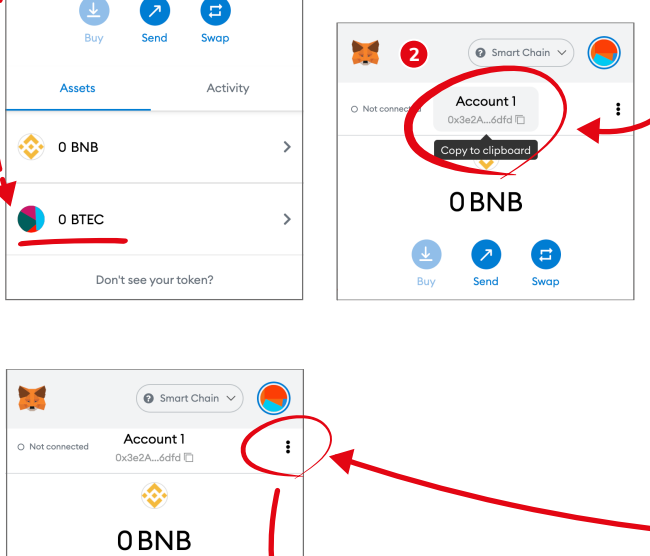

2

Register BTEC Token

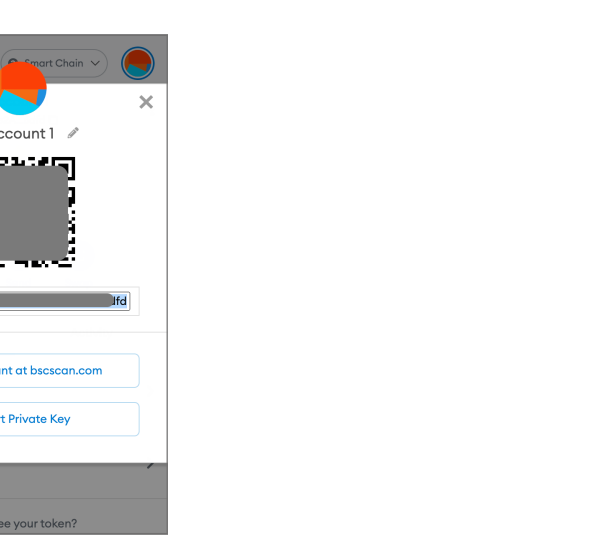
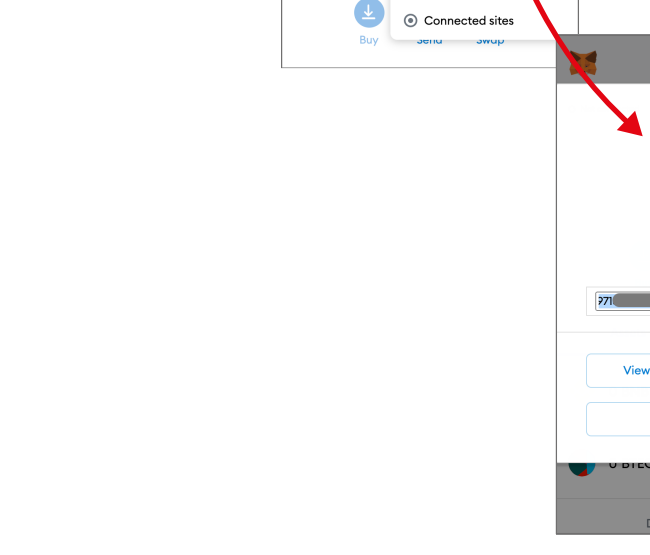

8 After creating the wallet, you will be redirected to the MetaMask home page. Tap on the top-left menu icon.

9 Tap on **Settings**.

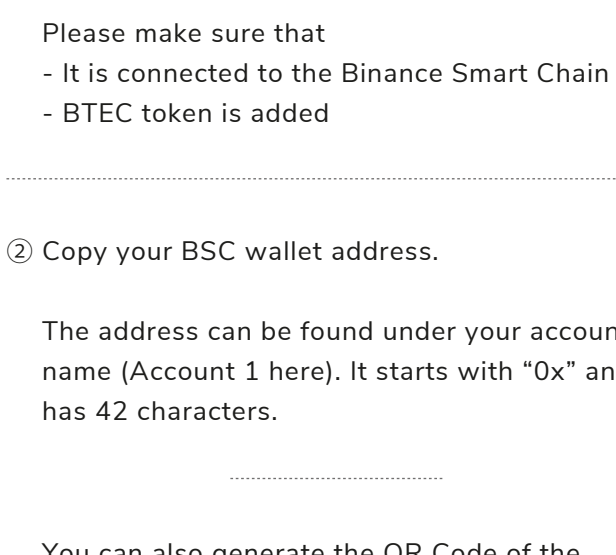
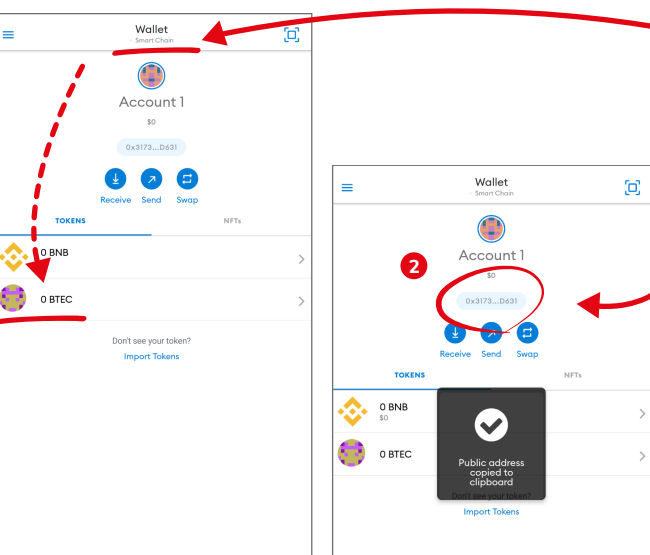

10 Tap on **Networks**.

11 Tap on **Add Network**.

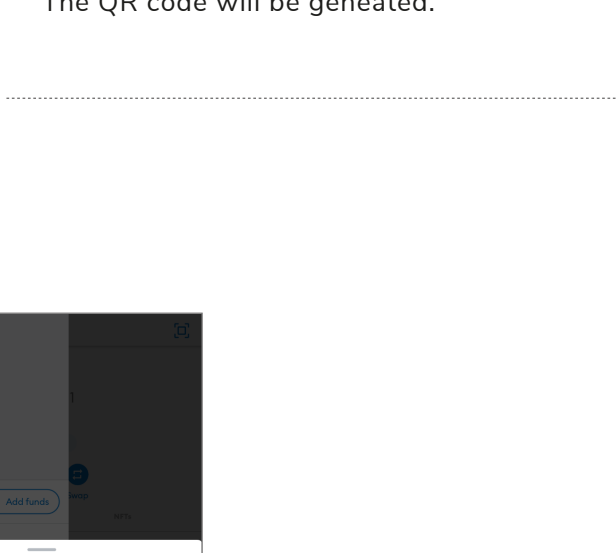
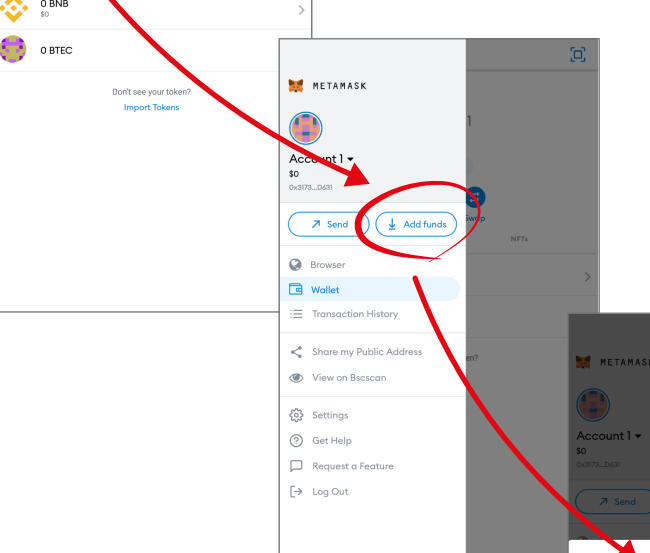

12 Fill in the information as below.

Network Name : Smart Chain
New RPC URL : <https://bsc-dataseed.binance.org/>
Chain ID : 56
Currency Symbol : BNB
Block Explorer URL : <https://bscscan.com>

13 When the network connection is complete, your MetaMask wallet will be switched to the Binance Smart Chain. Then, tap on **Import Tokens**.

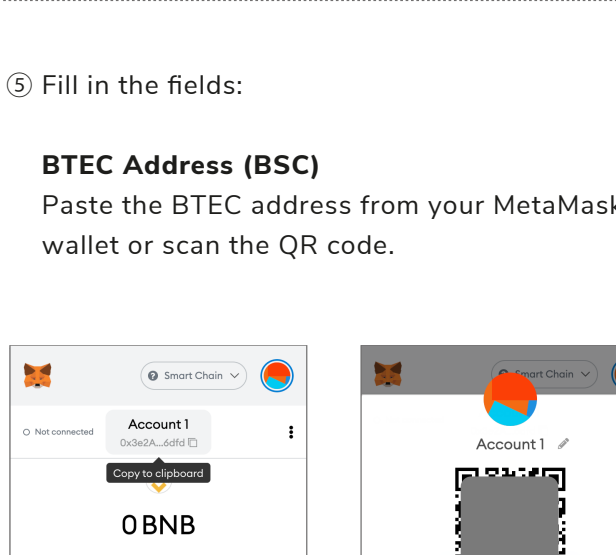
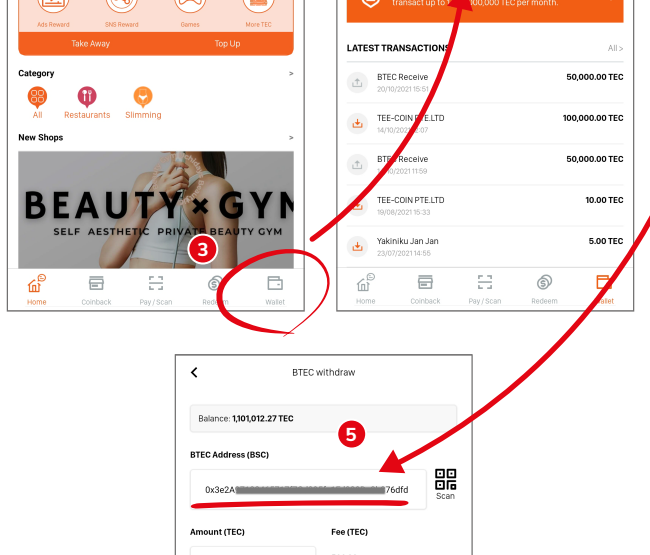
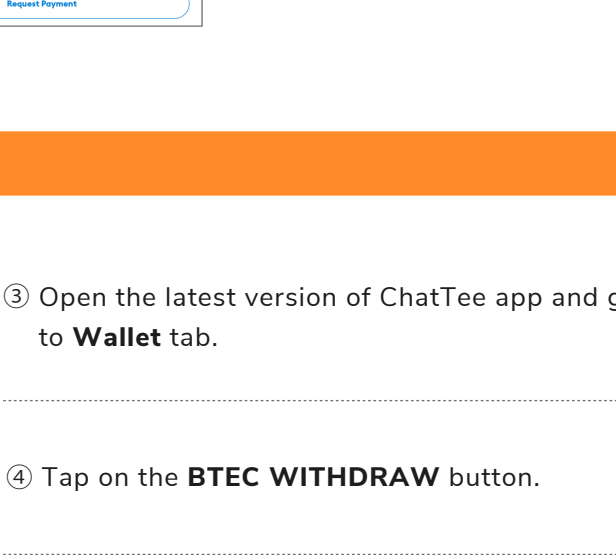
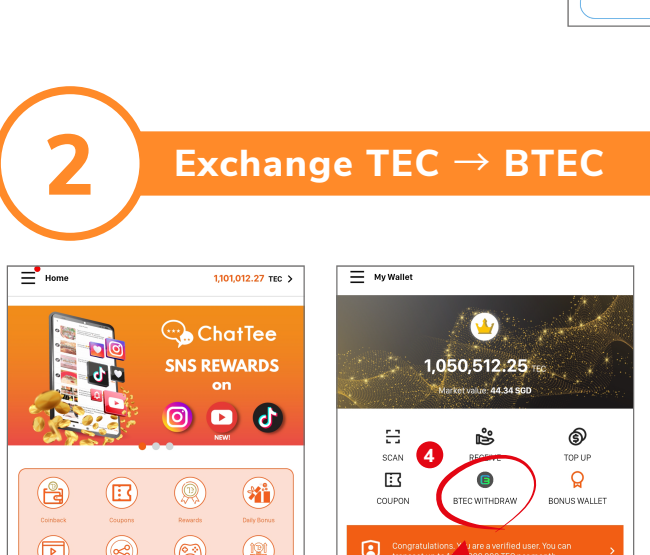

14 Fill in the information as below.

Token Contract Address :
0xaf307c4ea25c8a2a7029dc0322396a6b4b00a0fc
The Token Symbol and Token Decimal will be automatically filled in.
Tap on **IMPORT**.

15 BTEC token is now successfully added under your assets.

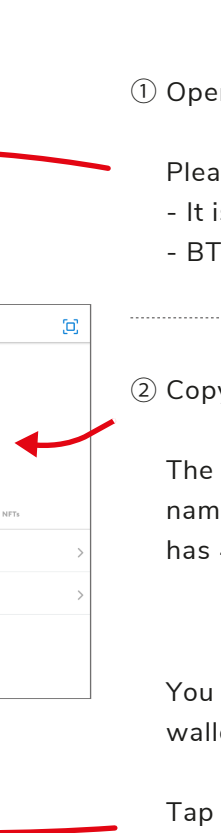
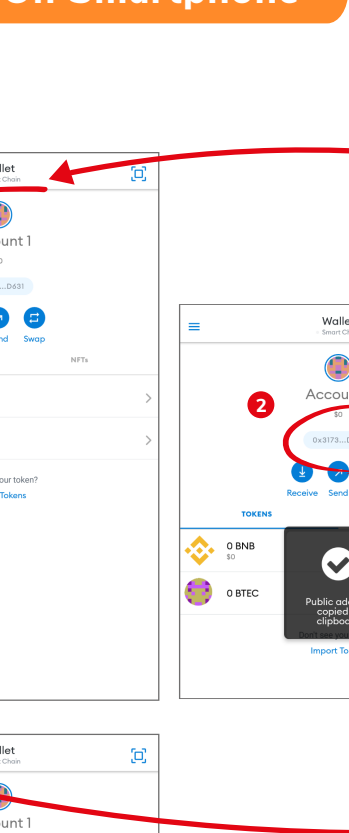
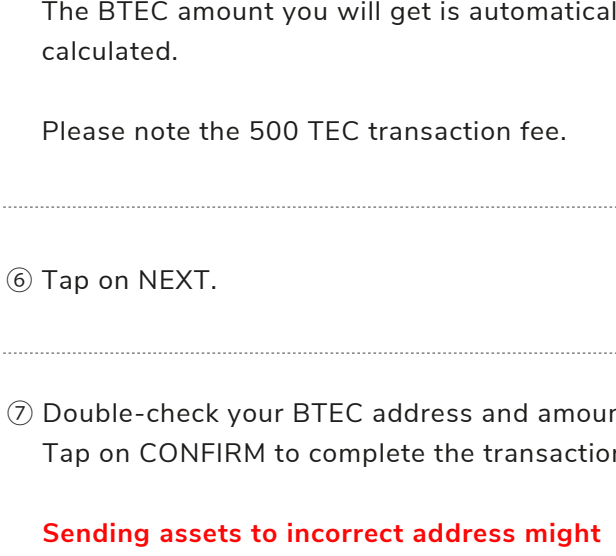
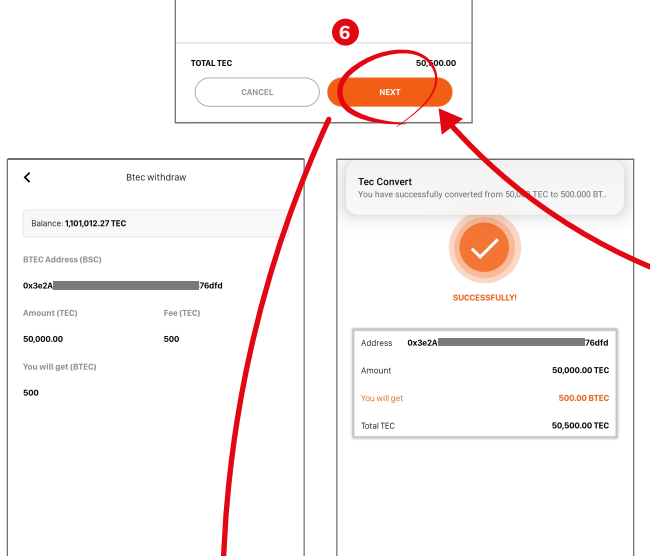

TEC → BTEC GUIDE

After setting up MetaMask wallet and adding BTEC token on Binance Smart Chain network, we can start exchanging BTEC and TEC on ChatTee app.

1

Copy Your Binance Smart Chain Wallet Address



On PC

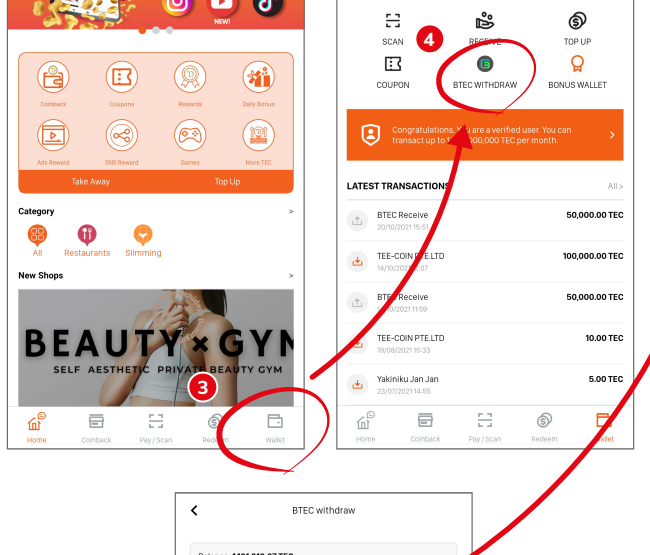

1 Open your MetaMask wallet.

Please make sure that
- It is connected to the Binance Smart Chain
- BTEC token is added

2 Copy your BSC wallet address.

The address can be found under your account name (Account 1 here). It starts with "0x" and has 42 characters.

You can also generate the QR Code of the wallet address.

Click on the vertical-3-dots button.

Then, click on Account details.

The QR code will be generated.

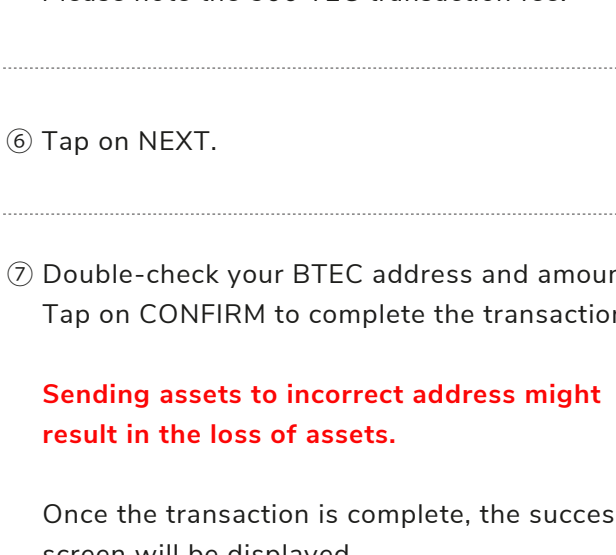
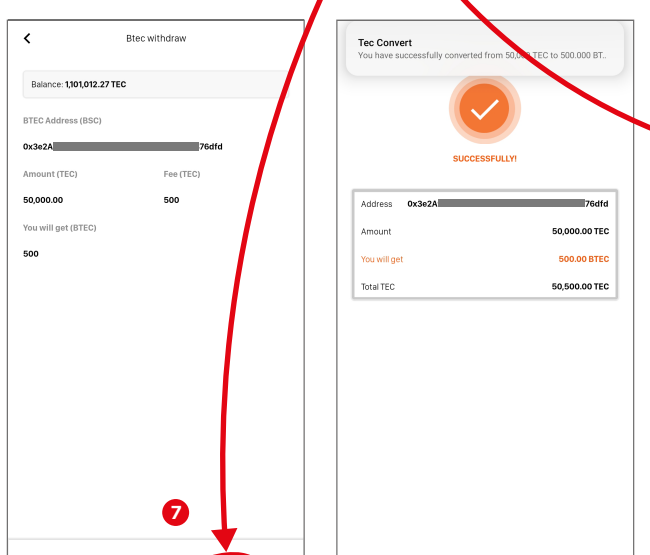
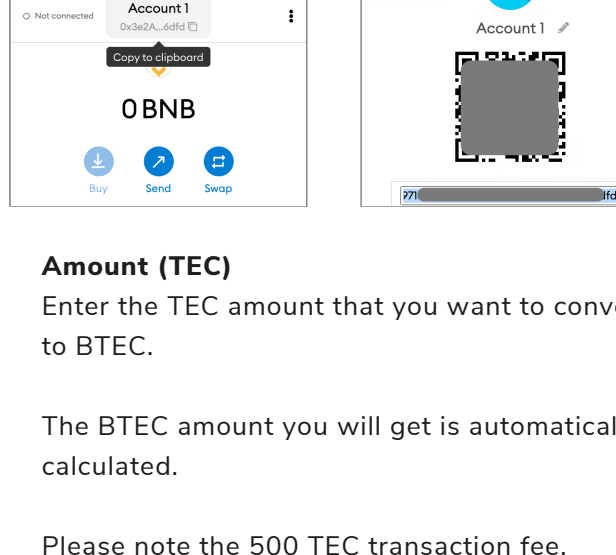
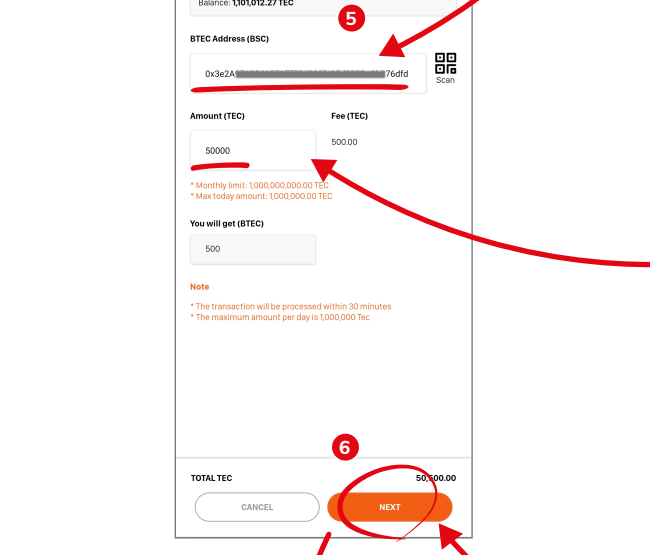

On Smartphone

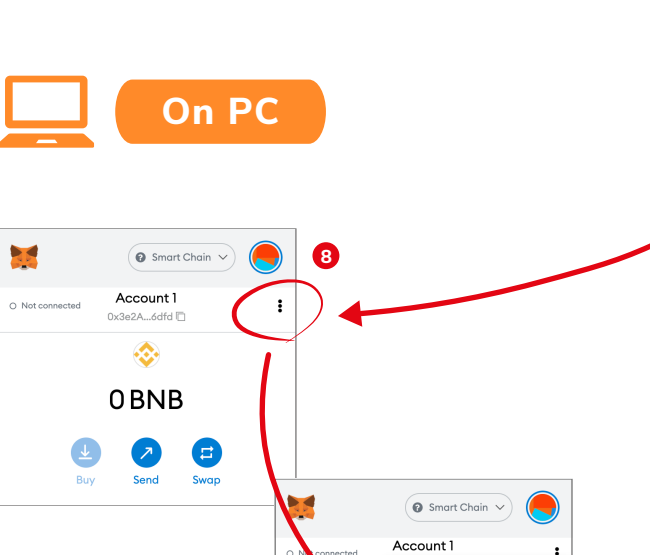

1 Open your MetaMask wallet app.

Please make sure that
- It is connected to the Binance Smart Chain
- BTEC token is added

2 Copy your BSC wallet address.

The address can be found under your account name (Account 1 here). It starts with "0x" and has 42 characters.

You can also generate the QR Code of the wallet address.

Tap on the top-left menu button.

Then, tap on **Add funds**.

The QR code will be generated.

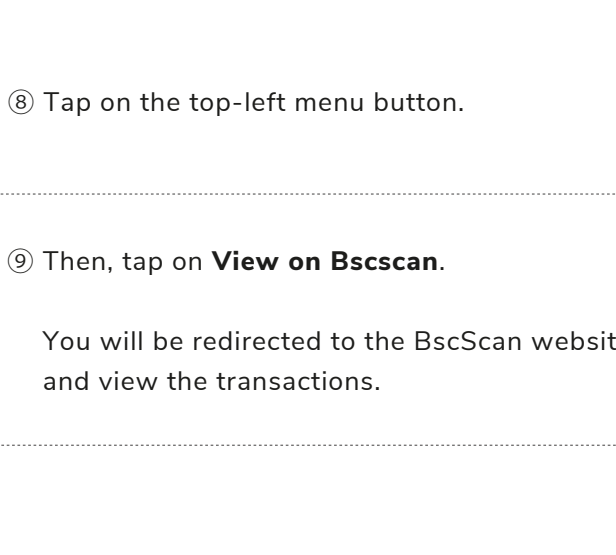
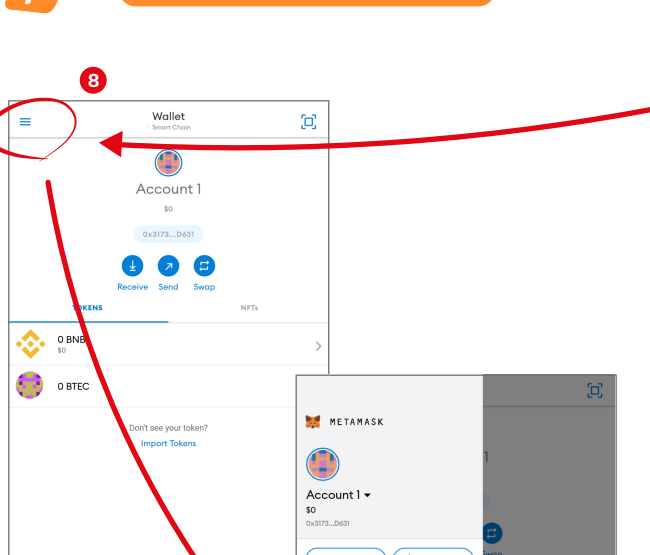
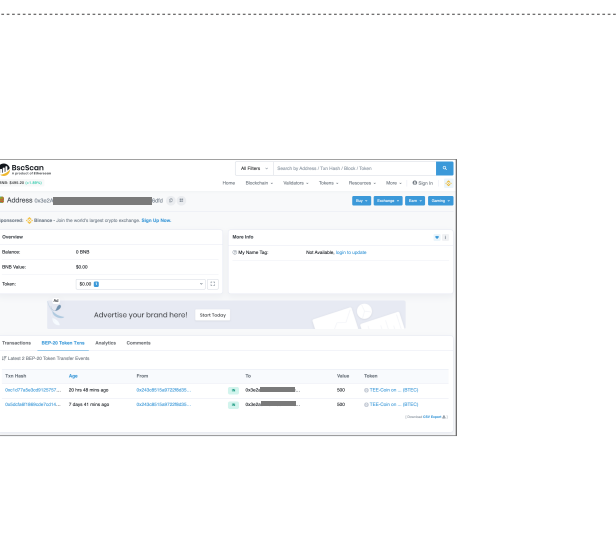
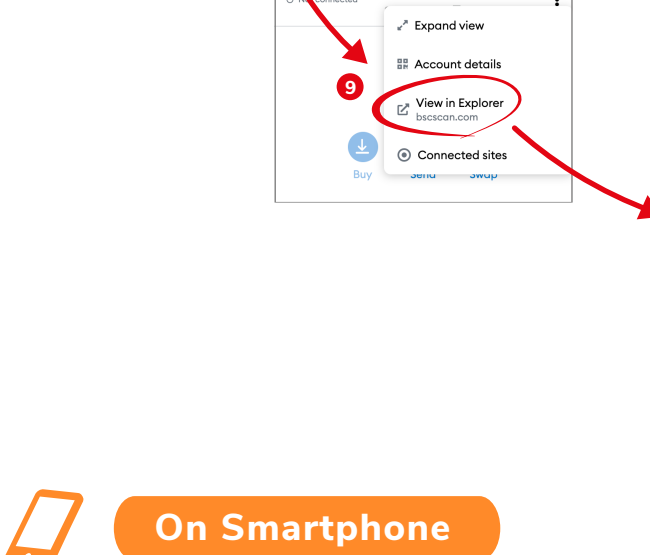

2

Exchange TEC → BTEC



3 Open the latest version of ChatTee app and go to **Wallet** tab.

4 Tap on the **BTEC WITHDRAW** button.

5 Fill in the fields:

Paste the Address (BSC)
Enter the BTEC address from your MetaMask wallet or scan the QR code.

Amount (TEC)
Enter the TEC amount that you want to convert to BTEC.
The BTEC amount you will get is automatically calculated.
Please note the 500 TEC transaction fee.

6 Tap on **NEXT**.

7 Double-check your BTEC address and amount. Tap on **CONFIRM** to complete the transaction.
Sending assets to incorrect address might result in the loss of assets.
Once the transaction is complete, the successful screen will be displayed.

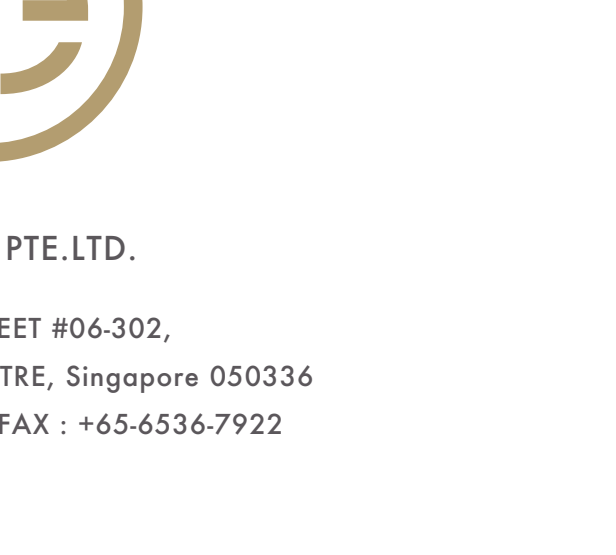

3

Check Your Transaction on Binane Smart Chain Explorer

You may check your transaction using the Binance Smart Chain Explorer on MetaMask wallet.

On PC

8 Click on the vertical-3-dots button.

9 Then, click on **View in Eplorer**.

You will be redirected to the BscScan website and view the transactions.

On Smartphone

8 Tap on the top-left menu button.

9 Then, tap on **View on Bscscan**.

You will be redirected to the BscScan website and view the transactions.

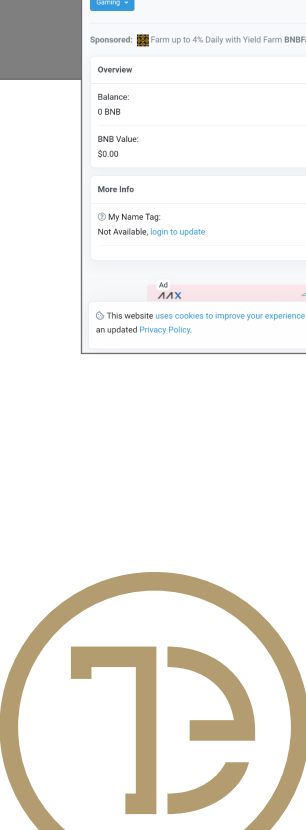

336 SMITH STREET #06-302,
NEW BRIDGE ROAD CENTRE, Singapore 050336
TEL : +65-6224-1495 FAX : +65-6536-7922